

Original 1967-75 dash or cluster housing
(Not Included with this kit)

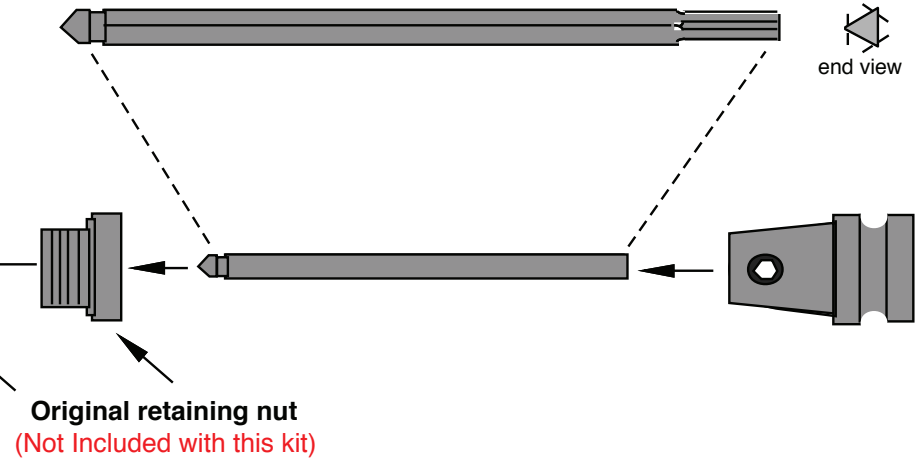

Original retaining nut
(Not Included with this kit)



NOTE: We have provided a new custom length shaft and knob in this kit. Below, we have included instructions on how to assemble it. However, if you would rather use your original knob/shaft assembly, it will work fine in this OE style replacement switch.

1. Install the new switch into your dash or cluster housing using the original retaining nut. It will be necessary to cut the shaft for a nice custom installation.
2. Install the shaft in switch being certain that it is fully engaged inside the switch. Once the shaft is fully seated down inside the switch in the "off" position, place the knob on end of shaft. Measure how far away from the dash or cluster housing the bottom face of the knob (closest to dash) is. Allow for 1/4" or so extra so that the knob will not bottom out on dash or cluster housing once the shaft has been cut to length.
3. Remove the shaft from the switch. To do this, pull the shaft completely out to the "on" position. Depress the button on the metal chassis side of the switch and simply pull the shaft out of the switch. Cut the shaft based on your measurements.
4. Attach the knob to the cut shaft and tighten the Allen head screw.
5. Reinstall your newly customized shaft into your headlight switch assembly.



**American
Autowire**

www.americanautowire.com 856-933-0801

PART #

510428

DESCRIPTION:

Headlight Switch
1967-75 Mopar A-Body
Classic Update Series

92971479 instruction sheet rev 0.0 10/20/2015